

## SERIE 300 Slim MC4 331 Slim

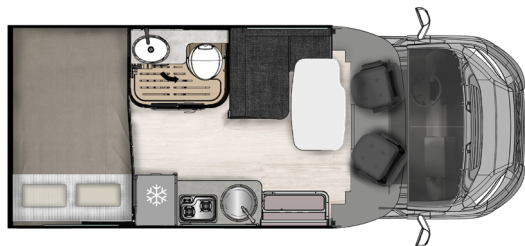

APPROVED SEATS	4
SLEEPS	2 (+1+1 OPT)
SEATS AT THE TABLE	4



### PACK

#### SERIES 300 SLIM PACK

- Engine 165 HP
- "High series" headlights with static cornering lights
- Glove box with lock
- Interior trim and "TREND" dashboard
- Bumpers and side mouldings in body colour
- Two-part locking door with window and central locking
- CP Plus control panel
- Panoramic roof
- Sink cover
- TV holder
- Seat covers
- 200 W solar panel with MPPT controller
- Pleated blind

#### FORD MATIC PACK – Series 300 Slim Pack required

- Automatic transmission
- "Matic" graphic pattern

#### DESIGN PACK – Series 300 Slim Pack and Matic Pack required

- Moondust Silver cab
- 16" alloy wheel rims

#### EXTRA ASSISTANCE PACK – Series 300 Slim Pack and Matic Pack required

- Electric windscreen defroster
- Pre-Collision Assist 2.2 (Medium Range Radar, Emergency Steering Assist and Collision Warning/Distance Indication - NCAP4)
- Adaptive Cruise Control with lane centring and Stop&Go
- Adaptive Cruise Control Integration with Traffic Sign Recognition
- Power-folding mirrors with electric defroster
- Navigation Centre

#### PLEIN AIR PACK

- Anthracite awning\*
- External gas socket
- Connection for external shower (garage)

\*3,5 meters on Mc4 Slim 337 and 339, 3 meters on Mc4 Slim 331

#### EXTRA WARM / EXTRA WARM DIESEL PACK

- COMBI 6 GAS + ELECTRIC / DIESEL + ELECTRIC heater
- Step insulation
- Winter Pack
- Electrically heated floor

#### 24" DIGITAL / SATELLITE TV PACK

- 24" Smart TV
- Digital / satellite antenna

#### 24" TV WI-FI PACK

- 24" Smart TV
- Wi-Fi Router

Chassis	
Engine, Power	2.0 TDI 130 HP
Maximum technically permissible weight (kg)	3500
Weight unladen in running conditions Min / Max (kg)	2815
Pay Load (kg)	685
Wheelbase (mm)	3300
Maximum towable weight (kg)	2000
Wheels dimensions	16"
Automatic air conditioning	S
Driver and Passenger airbag	S
Cruise Control with Intelligent Speed Assist	S
ABS / ESP	S/S
Driver and passenger swivelling seats	S
12" touch display / SYNC 4 infotainment system / 5G modem	S/S/S
Semi-digital 8" instrument panel	S
<b>Dimensions and places</b>	
External length (mm) / External width (mm)	5990 / 2150
External height(cm) / Internal height (cm)	285 / 204
Auxiliary bed in dinette	O
Rear Bed (cm)	201x129(119)
Dimensions Auxiliary bed in Dinette (cm)	188x101(50) (O)
Elevating Bed (cm)	190X90 (O)
Locker (useful opening, cm)	125x65 - 125x95
Max. internal garage height (cm)	125
Floor / walls / roof thickness (cm)	5,4 / 3 / 3
Floor / walls / roof material	MTS / VTR / VTR
Fiberglass roof, hail-proof	S
<b>Installations</b>	
Burners	2
Tank capacity: clear water / wastewater (l)	20(100) / 90
Automatic trivalent fridge ( 220V, 12V, gas ) (l)	137
Standard heating system	Combi Gas 4 kW
Space for 2 gas bottles (tot. Max 15 kg)	S
Integrated entry step	S
Heated garage locker	S
<b>Skylights</b>	
Rear skylight (mm)	S (400x400) / O (700x500)
Dinette skylight (mm)	S (700x500)
Toilette skylight (mm)	S (280x280)
Double-glazed windows with blind / mosquito net	S
<b>Equipments</b>	
Thermal blind	S
Beds with staves	S
Internal LED lightening	S
<b>Exteriors</b>	
Fog lights	S
Rear-view camera	S
Flyscreen for entrance door	S
XL entrance door	S
External LED light	S

S= standard O=optional VTR= Fibreglas MTS= multi-layered plywood  
The mass in running order includes the weight of the empty base vehicle, of the driver (75 kg), 100% of the fuel (60-l tank), fresh water (tank filled with 20 l while travelling), and aluminium gas cylinders (max 15 kg) filled to 90% of their capacity, and tolerance specified in the type-approval (+/- 5%) (2007/46/EC). Anything not included in the standard version of the vehicle, both living unit and chassis, results in an increase in weight in running order with resulting decreased payload up to the possible reduction of approved seats in the case of the total weight for the available payload value. The available payloads result from the difference between maximum permissible mass and running order mass and have a tolerance of 5%. During the purchase phase it is necessary to check the weight of the options to be installed on the vehicle.

# SERIE 300 Slim MC4 337 Slim

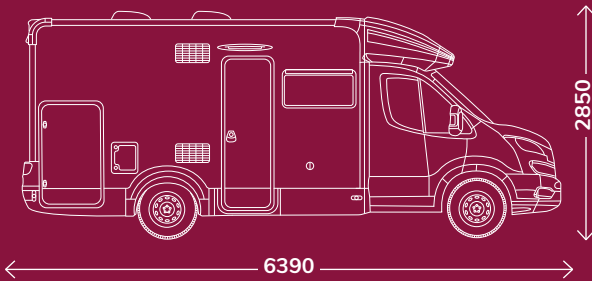

APPROVED SEATS	4
SLEEPS	2 (+2 OPT)
SEATS AT THE TABLE	4

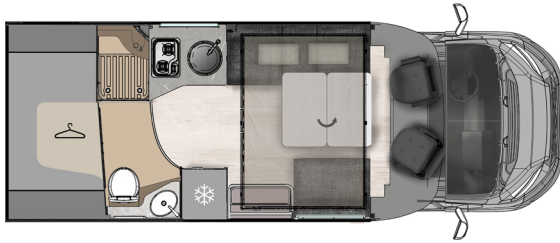

## PACK

### SERIES 300 SLIM PACK

- Engine 165 HP
- "High series" headlights with static cornering lights
- Glove box with lock
- Interior trim and "TREND" dashboard
- Bumpers and side mouldings in body colour
- Two-part locking door with window and central locking
- CP Plus control panel
- Panoramic roof
- Sink cover
- TV holder
- Seat covers
- 200 W solar panel with MPPT controller
- Pleated blind

### FORD MATIC PACK – Series 300 Slim Pack required

- Automatic transmission
- "Matic" graphic pattern

### DESIGN PACK – Series 300 Slim Pack and Matic Pack required

- Moondust Silver cab
- 16" alloy wheel rims

### EXTRA ASSISTANCE PACK – Series 300 Slim Pack and Matic Pack required

- Electric windscreen defroster
- Pre-Collision Assist 2.2 (Medium Range Radar, Emergency Steering Assist and Collision Warning/Distance Indication - NCAP4)
- Adaptive Cruise Control with lane centring and Stop&Go
- Adaptive Cruise Control Integration with Traffic Sign Recognition
- Power-folding mirrors with electric defroster
- Navigation Centre

### PLEIN AIR PACK

- Anthracite awning\*
- External gas socket
- Connection for external shower (garage)

\*3,5 meters on Mc4 Slim 337 and 339, 3 meters on Mc4 Slim 331

### EXTRA WARM / EXTRA WARM DIESEL PACK

- COMBI 6 GAS + ELECTRIC / DIESEL + ELECTRIC heater
- Step insulation
- Winter Pack
- Electrically heated floor

### 24" DIGITAL / SATELLITE TV PACK

- 24" Smart TV
- Digital / satellite antenna

### 24" TV WI-FI PACK

- 24" Smart TV
- Wi-Fi Router

Chassis	
Engine, Power	2.0 TDI 130 HP
Maximum technically permissible weight (kg)	3500
Weight unladen in running conditions Min / Max (kg)	2845
Pay Load (kg)	655
Wheelbase (mm)	3750
Maximum towable weight (kg)	2000
Wheels dimensions	16"
Automatic air conditioning	S
Driver and Passenger airbag	S
Cruise Control with Intelligent Speed Assist	S
ABS / ESP	S/S
Driver and passenger swivelling seats	S
12" touch display / SYNC 4 infotainment system / 5G modem	S/S/S
Semi-digital 8" instrument panel	S
Dimensions and places	
External length (mm) / External width (mm)	6390 / 2150
External height (cm) / Internal height (cm)	285 / 204
Auxiliary bed in dinette	O
Dimensions Auxiliary bed in Dinette (cm)	201X104(97) (O)
Elevating Bed (cm)	190X142
Locker (useful opening, cm)	170x68 - 120x68
Max. internal garage height (cm)	219
Floor / walls / roof thickness (cm)	5,4 / 3 / 3
Floor / walls / roof material	MTS / VTR / VTR
Fiberglass roof, hail-proof	S
Installations	
Burners	2
Tank capacity: clear water / wastewater (l)	20(100) / 100
Automatic trivalent fridge (220V, 12V, gas) (l)	137
Standard heating system	Combi Gas 4 kW
Space for 2 gas bottles (tot. Max 15 kg)	S
Integrated entry step	S
Heated garage locker	S
Skylights	
Rear skylight (mm)	S (400x400)
Central skylight (mm)	S (400x400)
Toilette skylight (mm)	S (280x280)
Double-glazed windows with blind / mosquito net	S
Equipments	
Thermal blind	S
Beds with staves	S
Internal LED lightening	S
Exteriors	
Fog lights	S
Rear-view camera	S
Flyscreen for entrance door	S
XL entrance door	S
External LED light	S

S= standard O=optional VTR= Fibreglas MTS= multi-layered plywood  
The mass in running order includes the weight of the empty base vehicle, of the driver (75 kg), 100% of the fuel (60-l tank), fresh water (tank filled with 20 l while travelling), and aluminium gas cylinders (max 15 kg) filled to 90% of their capacity, and tolerance specified in the type-approval (+/- 5%) (2007/46/EC). Anything not included in the standard version of the vehicle, both living unit and chassis, results in an increase in weight in running order with resulting decreased payload up to the possible reduction of approved seats in the case of the total weight for the available payload value. The available payloads result from the difference between maximum permissible mass and running order mass and have a tolerance of 5%. During the purchase phase it is necessary to check the weight of the options to be installed on the vehicle.

# SERIE 300 Slim MC4 339 Slim

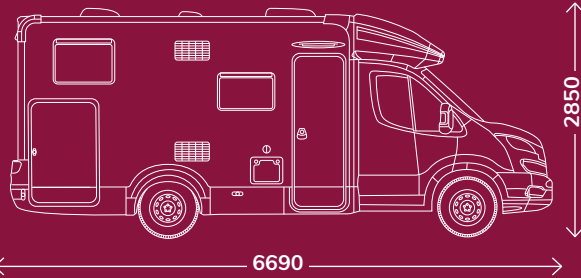

APPROVED SEATS	4
SLEEPS	2 (+1+1 OPT)
SEATS AT THE TABLE	4

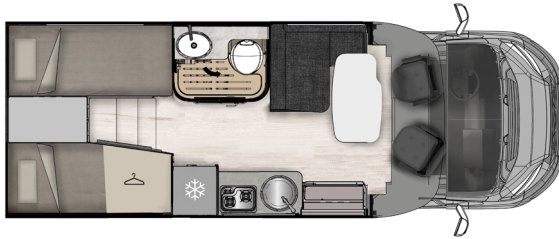

## PACK

### SERIES 300 SLIM PACK

- Engine 165 HP
- "High series" headlights with static cornering lights
- Glove box with lock
- Interior trim and "TREND" dashboard
- Bumpers and side mouldings in body colour
- Two-part locking door with window and central locking
- CP Plus control panel
- Panoramic roof
- Sink cover
- TV holder
- Seat covers
- 200 W solar panel with MPPT controller
- Pleated blind

### FORD MATIC PACK – Series 300 Slim Pack required

- Automatic transmission
- "Matic" graphic pattern

### DESIGN PACK – Series 300 Slim Pack and Matic Pack required

- Moondust Silver cab
- 16" alloy wheel rims

### EXTRA ASSISTANCE PACK – Series 300 Slim Pack and Matic Pack required

- Electric windscreen defroster
- Pre-Collision Assist 2.2 (Medium Range Radar, Emergency Steering Assist and Collision Warning/Distance Indication - NCAP4)
- Adaptive Cruise Control with lane centring and Stop&Go
- Adaptive Cruise Control Integration with Traffic Sign Recognition
- Power-folding mirrors with electric defroster
- Navigation Centre

### PLEIN AIR PACK

- Anthracite awning\*
- External gas socket
- Connection for external shower (garage)

\*3,5 meters on Mc4 Slim 337 and 339, 3 meters on Mc4 Slim 331

### EXTRA WARM / EXTRA WARM DIESEL PACK

- COMBI 6 GAS + ELECTRIC / DIESEL + ELECTRIC heater
- Step insulation
- Winter Pack
- Electrically heated floor

### 24" DIGITAL / SATELLITE TV PACK

- 24" Smart TV
- Digital / satellite antenna

### 24" TV WI-FI PACK

- 24" Smart TV
- Wi-Fi Router

Chassis	
Engine, Power	2.0 TDI 130 HP
Maximum technically permissible weight (kg)	3500
Weight unladen in running conditions Min / Max (kg)	2865
Pay Load (kg)	635
Wheelbase (mm)	3750
Maximum towable weight (kg)	2000
Wheels dimensions	16"
Automatic air conditioning	S
Driver and Passenger airbag	S
Cruise Control with Intelligent Speed Assist	S
ABS / ESP	S/S
Driver and passenger swivelling seats	S
12" touch display / SYNC 4 infotainment system / 5G modem	S/S/S
Semi-digital 8" instrument panel	S
<b>Dimensions and places</b>	
External length (mm) / External width (mm)	6690 / 2150
External height(cm) / Internal height (cm)	285 / 204
Auxiliary bed in dinette	O
Rear Bed (cm)	201x79 + 201x79 - 130x199
Dimensions Auxiliary bed in Dinette (cm)	188x101(50)
Elevating Bed (cm)	190X90 (O)
Additional seat rear bed	S
Locker (useful opening, cm)	S
Max. internal garage height (cm)	120x90 - 120x90
Floor / walls / roof thickness (cm)	5,4 / 3 / 3
Floor / walls / roof material	MTS / VTR / VTR
Fiberglass roof, hail-proof	S
<b>Installations</b>	
Burners	2
Tank capacity : clear water / wastewater (l)	20(100) / 90
Automatic trivalent fridge ( 220V, 12V, gas ) (l)	137
Standard heating system	Combi Gas 4 kW
Space for 2 gas bottles (tot. Max 15 kg)	S
Integrated entry step	S
Heated garage locker	S
<b>Skylights</b>	
Rear skylight (mm)	S (400x400) / O (700x500)
Dinette skylight (mm)	S (700x500)
Toilette skylight (mm)	S (280x280)
Double-glazed windows with blind / mosquito net	S
<b>Equipments</b>	
Thermal blind	S
Beds with staves	S
Internal LED lightening	S
<b>Exteriors</b>	
Fog lights	S
Rear-view camera	S
Flyscreen for entrance door	S
XL entrance door	S
External LED light	S

S= standard O=optional VTR= Fibreglas MTS= multi-layered plywood  
The mass in running order includes the weight of the empty base vehicle, of the driver (75 kg), 100% of the fuel (60-l tank), fresh water (tank filled with 20 l while travelling), and aluminium gas cylinders (max 15 kg) filled to 90% of their capacity, and tolerance specified in the type-approval (+/- 5%) (2007/46/EC). Anything not included in the standard version of the vehicle, both living unit and chassis, results in an increase in weight in running order with resulting decreased payload up to the possible reduction of approved seats in the case of the total weight for the available payload value. The available payloads result from the difference between maximum permissible mass and running order mass and have a tolerance of 5%. During the purchase phase it is necessary to check the weight of the options to be installed on the vehicle.



The masses indicated in the technical data sheets refer to the provisions of European Directive 2007/46/EC.

## **MASS IN RUNNING ORDER**

It includes the weight of the empty base vehicle, of the driver (75 kg), 100% of the fuel (60-l tank), fresh water (tank filled with 20 l while travelling), and a gas tank for living purposes (20 kg). The mass in running order, and consequently the payload and/or certified seats may vary depending on the accessories installed.

## **PAYLOAD**

This consists of the difference between the maximum technically permissible laden mass and the mass in running order. It includes elements for living purposes, the transported passengers defined by the manufacturer (driver excluded), and the personal effects.

The payload calculation is based on the following parameters: 75 kg for each passenger (driver excluded), 10 kg of baggage for each passenger and for the driver, 10 kg for each metre of length of the vehicle, plus the remaining payload, which can be used for the installation of accessories or for additional baggage.

All masses and loads of the empty vehicle have a tolerance of +/- 5%, in compliance with Directive 2007/46/EC.

Any optional equipment increases the mass in running order and decreases the payload.

The weight of non-standard accessories is not included in the mass in running order indicated in this catalogue. Additional accessories and devices reduce the payload by a quantity equal to their weight; the incidence of the weight of the individual accessories is shown in the special column in the technical data sheets or can be requested at our dealers. In case certain accessories are installed (for example, additional elements such as coupling device or motorbike rack), the mass of these accessories will affect the payload, possibly reducing it along with the number of certified seats. Please note that the law does not allow the maximum permissible mass to be exceeded, which can be consulted under the specific heading of the data sheets. Please make sure that the maximum loads on the axles and the maximum technically permissible load mass are not exceeded during the complete loading phase of the vehicle. The regulations and requirements of each country may entail changes in the characteristics of this table. The number of certified seats may vary depending on the traffic regulations in force in each country. When driving, the fresh water tank must be filled to a maximum of 20 litres.